

Phonak TVLink II

Quick setup guide / Schnellstartanleitung

Guide d'installation rapide / Guía rápida de conexión



PHONAK
life is on

Components
Komponenten
Composants
Componentes

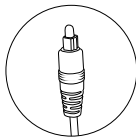

Optical

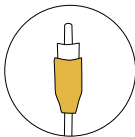

Coaxial



ComPilot II

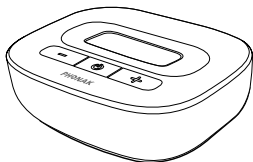
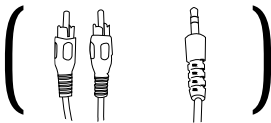

Phonak TVLink II
basestation

Connect power and audio cable

Netzteil und Audio-Kabel anschliessen

Connectez le câble d'alimentation et le câble audio

Conecte el cable de conexión y el de audio

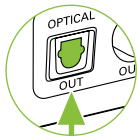
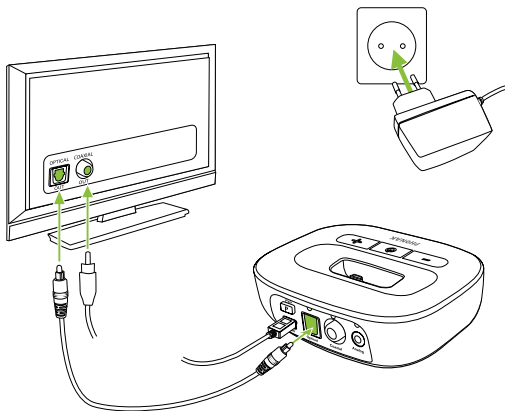

or
oder
ou
o



2

□■□□□

Charge 1 hour
1 Stunde laden
Chargez 1 heure
Cargar 1 ora

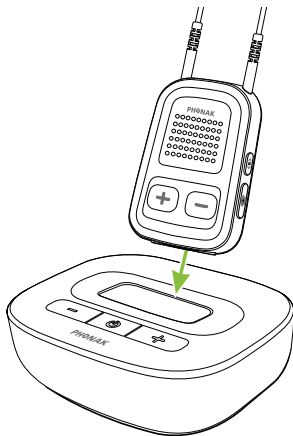

Wearing ComPilot II

ComPilot II tragen

Portez ComPilot II

Llevar ComPilot II

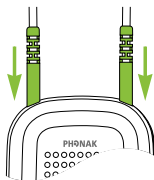
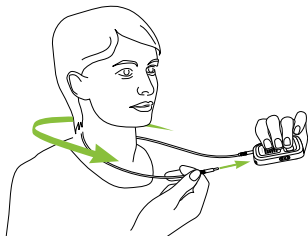
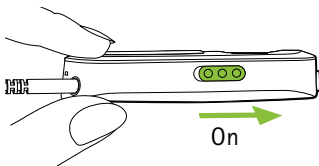

Switch on TVLink II
TVLink II einschalten
Mettez TVLink II en marche
Encienda TVLink II

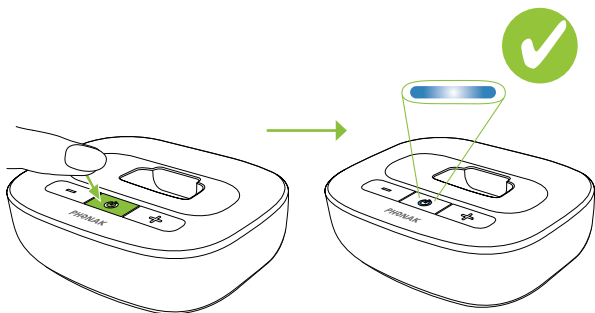

Usage
Benützung
Utilisation
Utilización

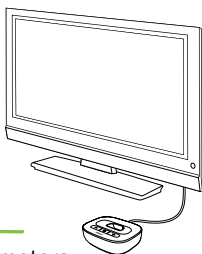

Up to 30 meters
(100 ft)

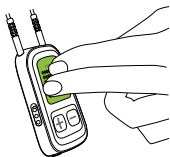

Pause / Resume
Pause / Abspielen
Pause / Diffuser
Pausar / Reanudar

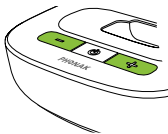

Volume setting
Lautstärke einstellen
Réglage de volume
Ajuste de volumen



The Phonak TVLink II user guide will give you detailed information about the installation.

Die Phonak TVLink II Gebrauchsanweisung informiert detailliert über die Installation.

Le mode d'emploi Phonak TVLink II vous donne des informations détaillées sur l'installation.

Las instrucciones de uso del Phonak TVLink II le darán una información más detallada sobre su instalación.



ON
Ein
Marche
Encendido



No audio signal
Kein Audiosignal
Pas de signal audio
No hay señal audio



Audio transmission
Tonübertragung
Transmission audio
Transmisión audio



Pause
Pause
Pause
No transmisión



Pairing
Koppeln
Couplage
Emparejamiento



Phonak AG
Laubisrütistrasse 28
CH-8712 Stäfa
Switzerland

www.phonak.com

